

SPECIFICATIONS :-

- Spacious Offices & Multi purpose House
- Two level basement exclusively parking as well as ample parking at ground Level front and back Side.
- Aesthetically designed building.
- Earthquake resistant R.C.C. structure.
- stair steps in granite and grenamite flooring in lift passage and other areas excluding offices.
- High end lift feeding all levels including parking which includes 2 nos lifts for visitors and 1 nos Stretcher or goods lift.

AMINITIES :-

- Facility of fire fighting system.
- Facility of intercom for each office connected with ground floor reception area.
- Round the clock water supply.
- Facility of wi-fi system.
- Office area with basic wiring including complete air conditioner load.
- 100% power backup for passage area, lift, reception area and surrounding of building.
- Name plate in reception area of building.

DEVELOPERS

OM INFRA

ARCHITECT

HASNUKH PATEL
& ASSOCIATES

STRUCTURE

TECHNOCRAFT
CONSULTANT

website : www.shubhgroup.in
e-mail : info@shubhgroup.in
Contact : +91 9377711011, +91 98251 60860

A Project by

शुभ
GROUP

A Saga Begins...



शुभ

Universal

T.P. 1, Nr. B.R.T.S., VESU



ON TO BASEMENT

24.00 M T W I D E R O A D

GROUND FLOOR PLAN

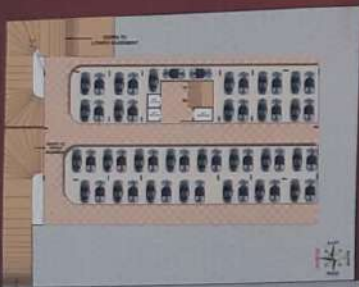

24.00 M T W I D E R O A D

UPPER BASEMENT (PARKING)

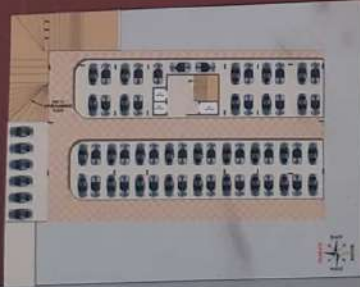

24.00 M T W I D E R O A D

LOWER BASEMENT (PARKING)

Universal



UPPER GROUND FLOOR PLAN



TYPICAL FLOOR PLAN (1st to 6th)